

No 24

No 863 of Do. Co. Land

No 866 of Do. Co. Land

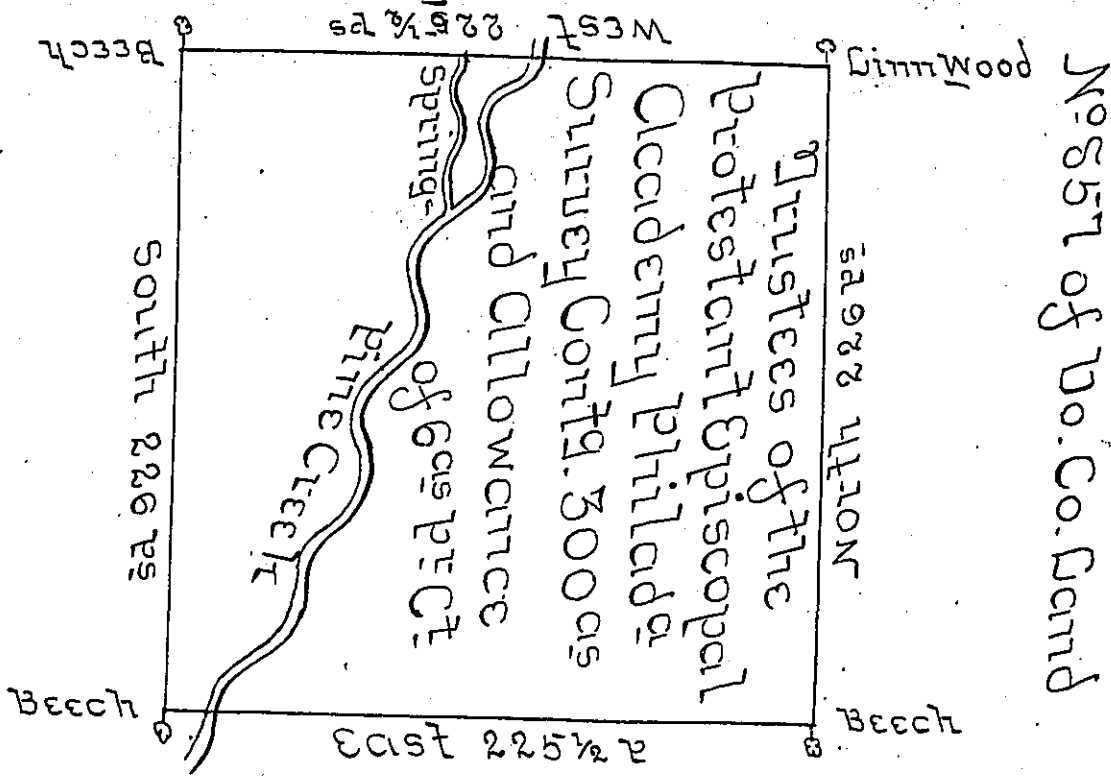

No 857 of Do. Co. Land

No 865 of Do. Co. Land

A Draught of a tract of land situated in the late purchase on the head waters of the East branch of Pine creek, and about twenty two miles from the West branch of Susquehanna - Surveyed for the Trustees of the Protestant Episcopal Academy of Philada September - one thousand seven hundred and eighty eight, on a Warrant number eight hundred and sixty four - Containing three hundred acres and allowance.

Saml Edmiston

D.S.

John Lukens Esq }
 S Genl }

IN TESTIMONY that the above is a copy of the original remaining on file in the Department of Internal Affairs of Pennsylvania, made conformably to an Act of Assembly approved the 16th day of February, 1833, I have hereunto set my Hand and caused the Seal of said Department to be affixed at Harrisburg, this eighteenth day of October 1904.

Isaac D. Brown
 Secretary of Internal Affairs